

型號 / type

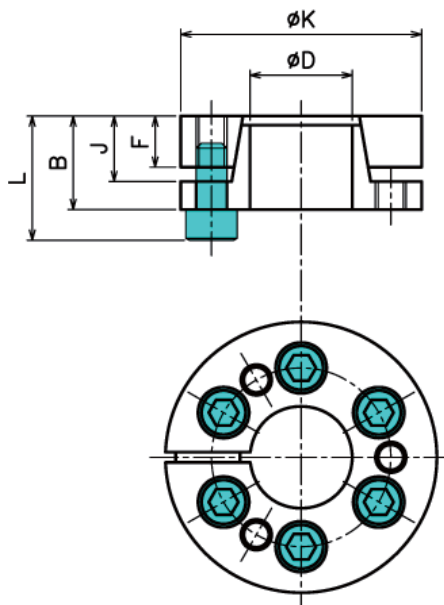

免鍵式軸環-自動校心型

單位 / Unit : mm



| 規格 NO | D | K | F | J | B | L | M | 常用扭力 (N.m) | 軸向荷重 (kN) | 輪側面壓 (N/mm ²) | 重量 (kg) |
|--------|-----|-----|------|------|------|------|-----|------------|-----------|---------------------------|---------|
| DS-06 | 6 | 19 | 8 | 10.5 | 13.5 | 16.5 | M3 | 6.2 | 4 | 53 | 0.02 |
| DS-08 | 8 | 22 | 10 | 13 | 17 | 21 | M4 | 18 | 4.7 | 70 | 0.03 |
| DS-09 | 9 | 23 | 10 | 13 | 17 | 21 | M4 | 21 | 4.7 | 68 | 0.04 |
| DS-10 | 10 | 24 | 10 | 13 | 17 | 21 | M4 | 30 | 6.2 | 87 | 0.06 |
| DS-11 | 11 | 25 | 10 | 13 | 17 | 21 | M4 | 34 | 6.2 | 84 | 0.06 |
| DS-12 | 12 | 26 | 10 | 13 | 17 | 21 | M4 | 47 | 7.8 | 100 | 0.07 |
| DS-13 | 13 | 27 | 10 | 13 | 17 | 21 | M4 | 50 | 7.8 | 97 | 0.08 |
| DS-14 | 14 | 31 | 12.5 | 16 | 21 | 26 | M5 | 70 | 10 | 87 | 0.08 |
| DS-15 | 15 | 32 | 12.5 | 16 | 21 | 26 | M5 | 75 | 10 | 84 | 0.08 |
| DS-16 | 16 | 33 | 12.5 | 16 | 21 | 26 | M5 | 80 | 10 | 81 | 0.08 |
| DS-17 | 17 | 34 | 12.5 | 16 | 21 | 26 | M5 | 105 | 12.5 | 99 | 0.09 |
| DS-18 | 18 | 35 | 12.5 | 16 | 21 | 26 | M5 | 110 | 12.5 | 96 | 0.1 |
| DS-19 | 19 | 47 | 17 | 22 | 28 | 34 | M6 | 290 | 30 | 94 | 0.26 |
| DS-20 | 20 | 47 | 17 | 22 | 28 | 34 | M6 | 320 | 32 | 100 | 0.25 |
| DS-22 | 22 | 47 | 17 | 22 | 28 | 34 | M6 | 320 | 32 | 100 | 0.25 |
| DS-24 | 24 | 50 | 17 | 22 | 28 | 34 | M6 | 360 | 32 | 100 | 0.27 |
| DS-25 | 25 | 50 | 17 | 22 | 28 | 34 | M6 | 420 | 34 | 100 | 0.27 |
| DS-28 | 28 | 55 | 17 | 22 | 28 | 34 | M6 | 500 | 34 | 100 | 0.32 |
| DS-30 | 30 | 55 | 17 | 22 | 28 | 34 | M6 | 520 | 34 | 100 | 0.35 |
| DS-32 | 32 | 60 | 17 | 22 | 28 | 34 | M6 | 770 | 48 | 110 | 0.37 |
| DS-35 | 35 | 60 | 17 | 22 | 28 | 34 | M6 | 840 | 48 | 110 | 0.34 |
| DS-38 | 38 | 65 | 17 | 22 | 28 | 34 | M6 | 910 | 48 | 110 | 0.4 |
| DS-40 | 40 | 65 | 17 | 22 | 28 | 34 | M6 | 960 | 48 | 110 | 0.38 |
| DS-42 | 42 | 75 | 20 | 25 | 33 | 41 | M8 | 1000 | 65 | 110 | 0.65 |
| DS-45 | 45 | 75 | 20 | 25 | 33 | 41 | M8 | 1500 | 65 | 110 | 0.63 |
| DS-48 | 48 | 80 | 20 | 25 | 33 | 41 | M8 | 2000 | 85 | 140 | 0.7 |
| DS-50 | 50 | 80 | 20 | 25 | 33 | 41 | M8 | 2100 | 85 | 140 | 0.68 |
| DS-55 | 55 | 85 | 20 | 25 | 33 | 41 | M8 | 2500 | 95 | 140 | 0.73 |
| DS-60 | 60 | 90 | 20 | 25 | 33 | 41 | M8 | 2700 | 90 | 130 | 0.78 |
| DS-65 | 65 | 95 | 20 | 25 | 33 | 41 | M8 | 3200 | 100 | 140 | 0.83 |
| DS-70 | 70 | 110 | 24 | 30 | 40 | 50 | M10 | 4900 | 140 | 140 | 1.33 |
| DS-75 | 75 | 115 | 24 | 30 | 40 | 50 | M10 | 5300 | 140 | 130 | 1.4 |
| DS-80 | 80 | 120 | 24 | 30 | 40 | 50 | M10 | 5600 | 140 | 130 | 1.48 |
| DS-85 | 85 | 125 | 24 | 30 | 40 | 50 | M10 | 6700 | 160 | 130 | 1.55 |
| DS-90 | 90 | 130 | 24 | 30 | 40 | 50 | M10 | 7100 | 160 | 130 | 1.65 |
| DS-95 | 95 | 135 | 24 | 30 | 40 | 50 | M10 | 9100 | 195 | 135 | 1.7 |
| DS-100 | 100 | 145 | 26 | 32 | 44 | 56 | M12 | 10200 | 200 | 150 | 2.6 |
| DS-110 | 110 | 155 | 26 | 32 | 44 | 56 | M12 | 10600 | 200 | 150 | 2.8 |
| DS-120 | 120 | 165 | 26 | 32 | 44 | 56 | M12 | 13000 | 216 | 140 | 3 |
| DS-130 | 130 | 180 | 34 | 40 | 54 | 64 | M12 | 18900 | 290 | 135 | 4.6 |
| DS-140 | 140 | 190 | 34 | 40 | 54 | 68 | M14 | 20500 | 333 | 125 | 4.9 |
| DS-150 | 150 | 200 | 34 | 40 | 54 | 68 | M14 | 25000 | 362 | 120 | 5.2 |
| DS-160 | 160 | 210 | 34 | 40 | 54 | 68 | M14 | 29000 | 362 | 130 | 5.5 |
| DS-170 | 170 | 225 | 44 | 50 | 64 | 78 | M14 | 34000 | 400 | 135 | 7.75 |
| DS-180 | 180 | 235 | 44 | 50 | 64 | 78 | M14 | 36000 | 400 | 120 | 8.15 |
| DS-190 | 190 | 250 | 44 | 50 | 64 | 78 | M14 | 47500 | 500 | 115 | 9.5 |
| DS-200 | 200 | 265 | 44 | 50 | 64 | 78 | M14 | 50000 | 500 | 140 | 9.9 |